

Swiftreader X - shade installation

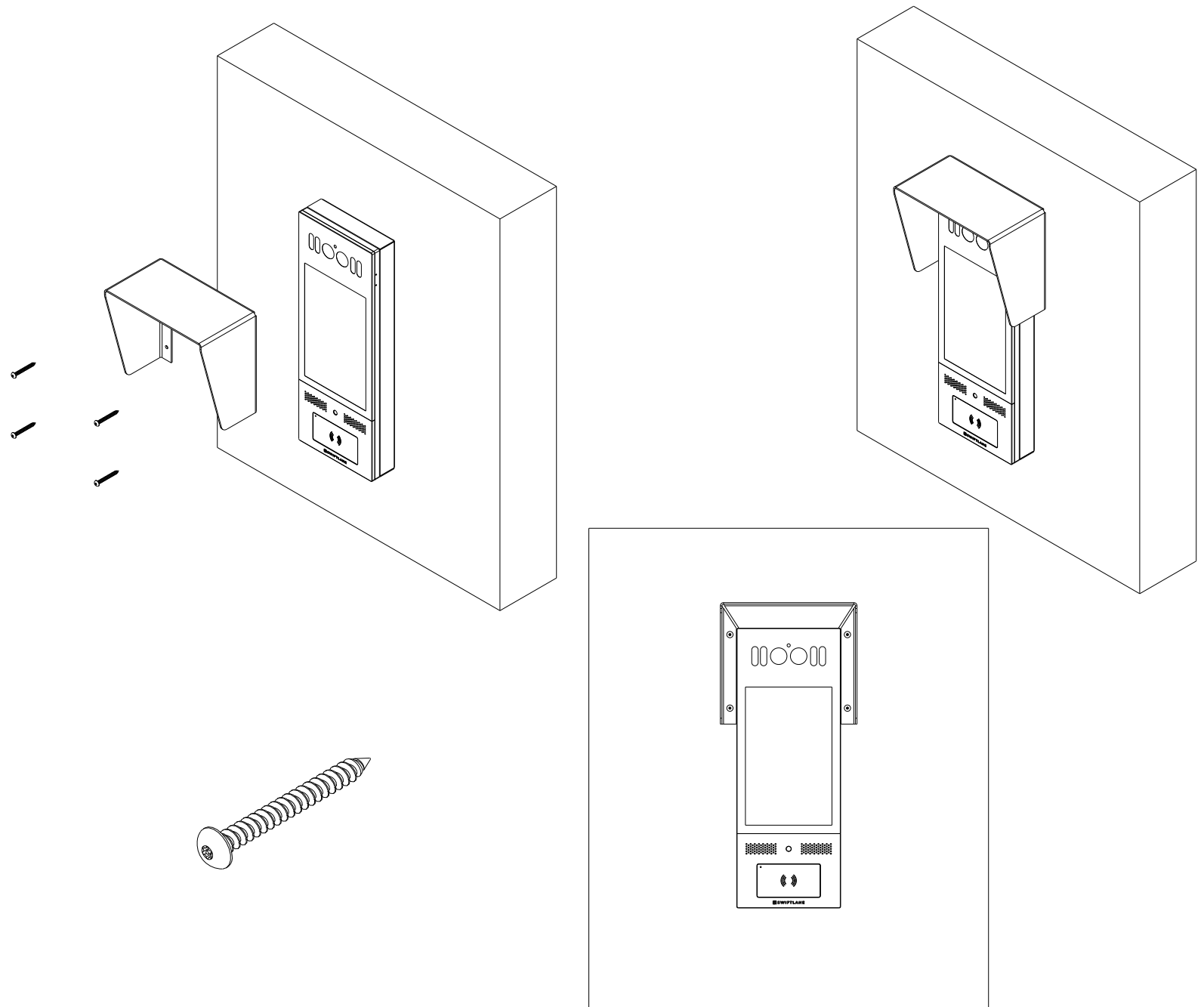

- Mount the shade using 4 rounded head No8 screws
- Screws should be tamper resistant - color should match the color of the shade
- Use the shade to mark/drill the locations for the screws
- Shade should be touching the top side of the back cover

See all installation manuals:
<https://www.swiftlane.com/swiftlane-installation-manual/>
Scan QR code to visit all installation manuals

Support
support@swiftlane.com
833-60-SWIFT / 833-607-9438

Sales
contact@swiftlane.com
505-65-SWIFT / 505-657-9438



SWIFTLANE

Swiftlane Inc.
743 Clementina St., San Francisco, CA

Website: <https://www.swiftlane.com>