

# Swiftreader X - postal lock assembly for surface - overview

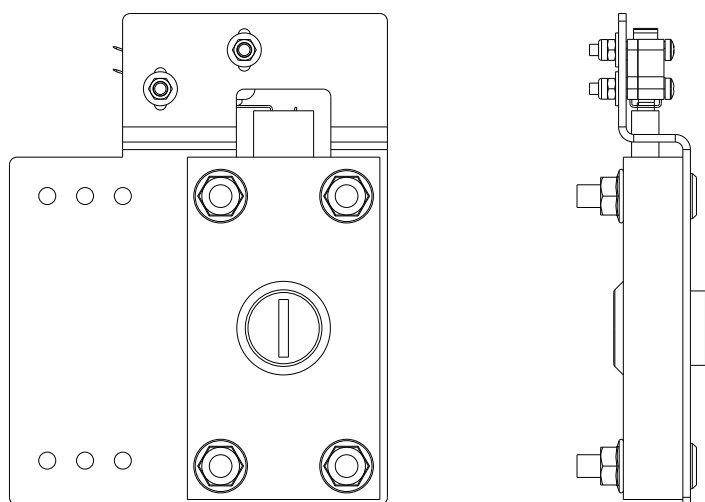

# Swiftreader X - postal lock assembly adjustment

Vertical position of the switch should be adjusted and nuts tightened before the assembly is fixed on the finishing plate

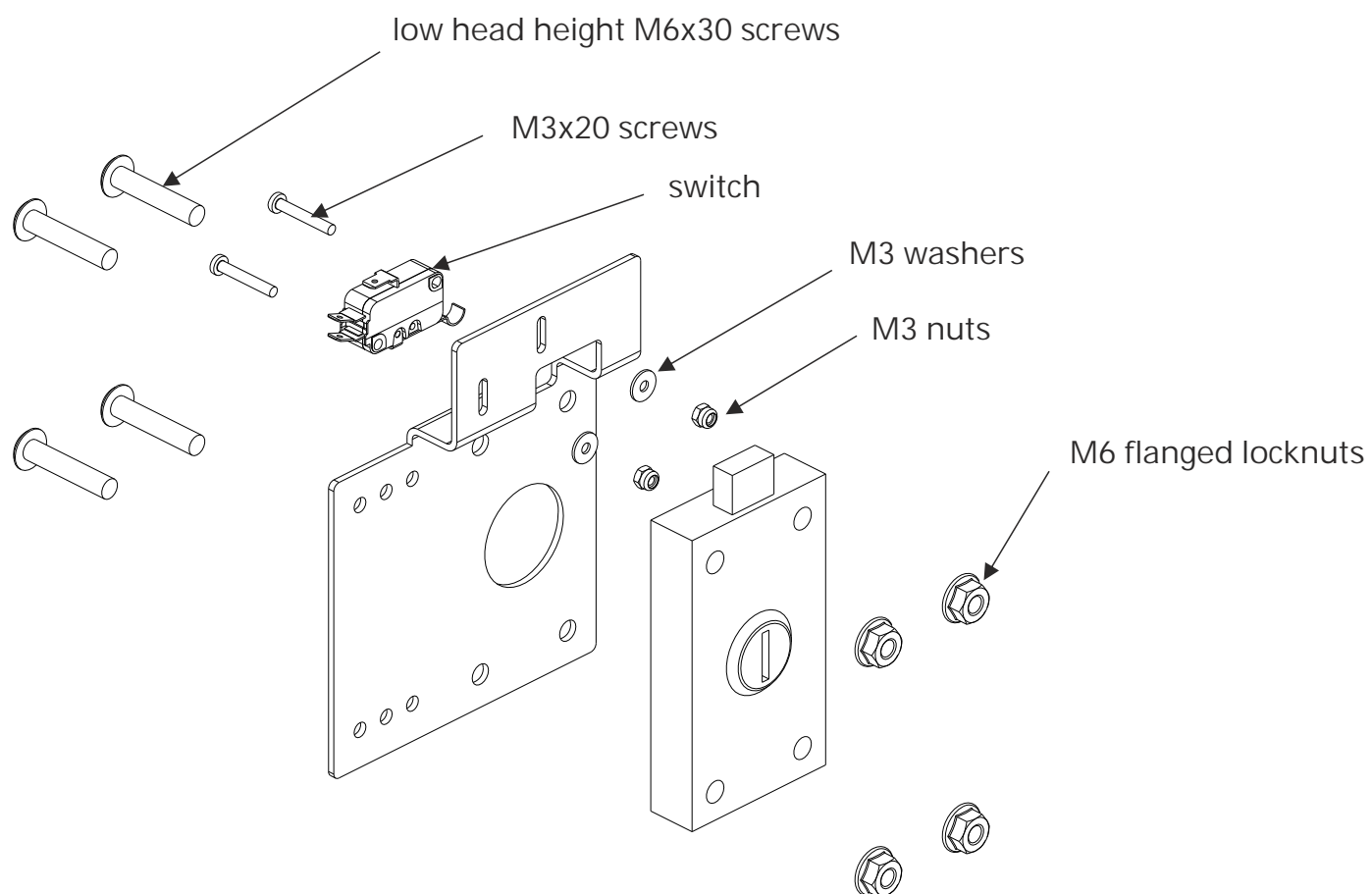
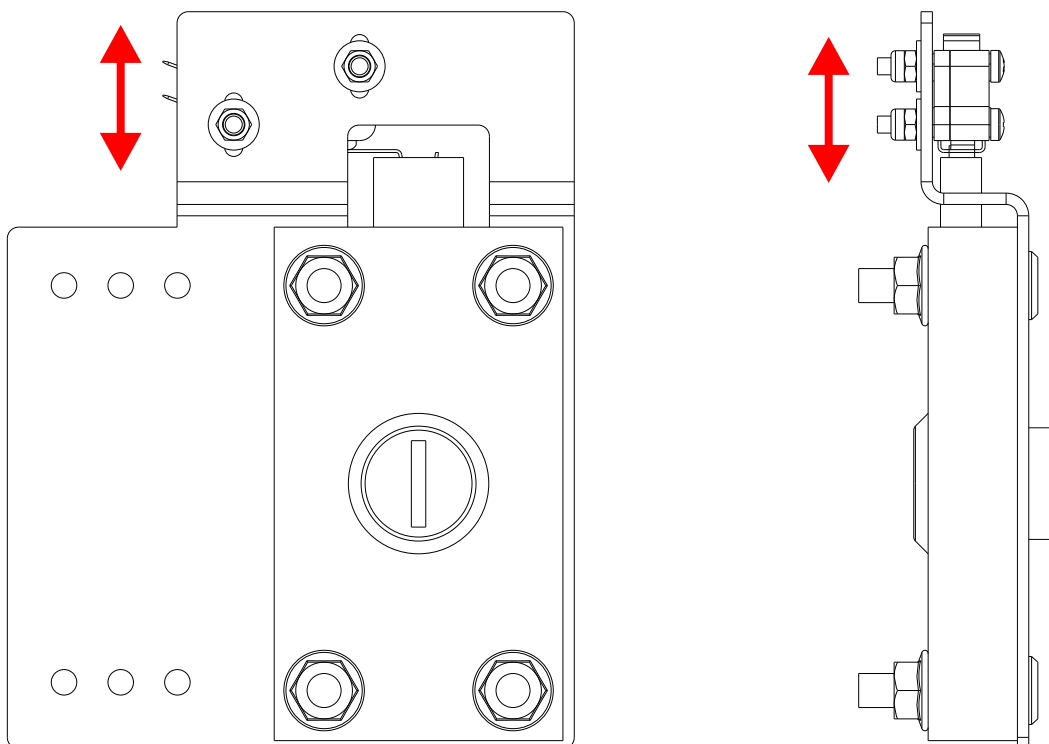

# Swiftreader X - postal lock assembly installation

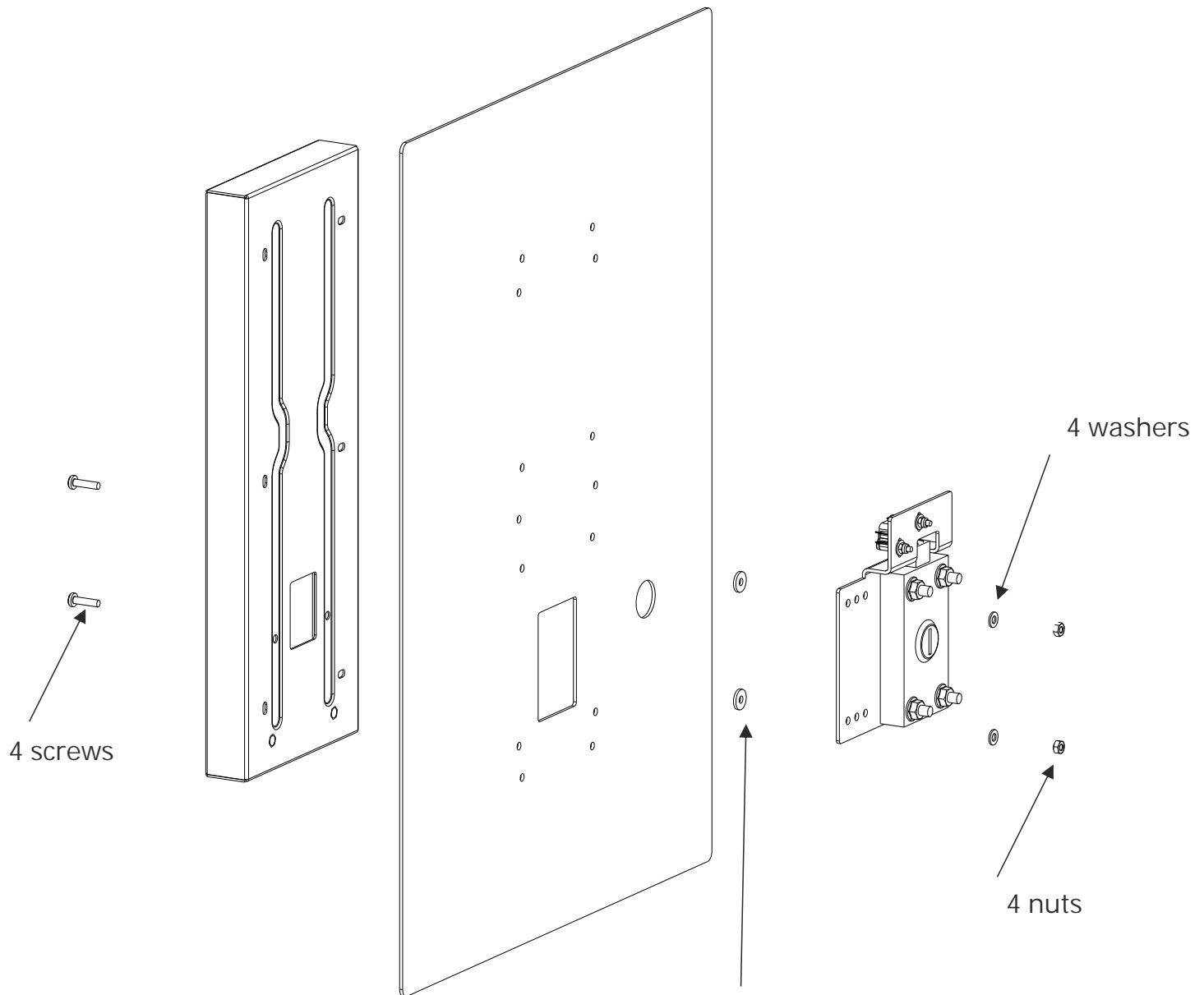

large diameter washers  
used to adjust the distance of the cylinder's face  
from the face of the finishing plate  
we try to keep a small distance  
more than one per location can be used if required

# Swiftreader X - postal lock assembly installation

Fixation screws should be inside the surface back cover  
- visible screws on the finishing plate should be avoided

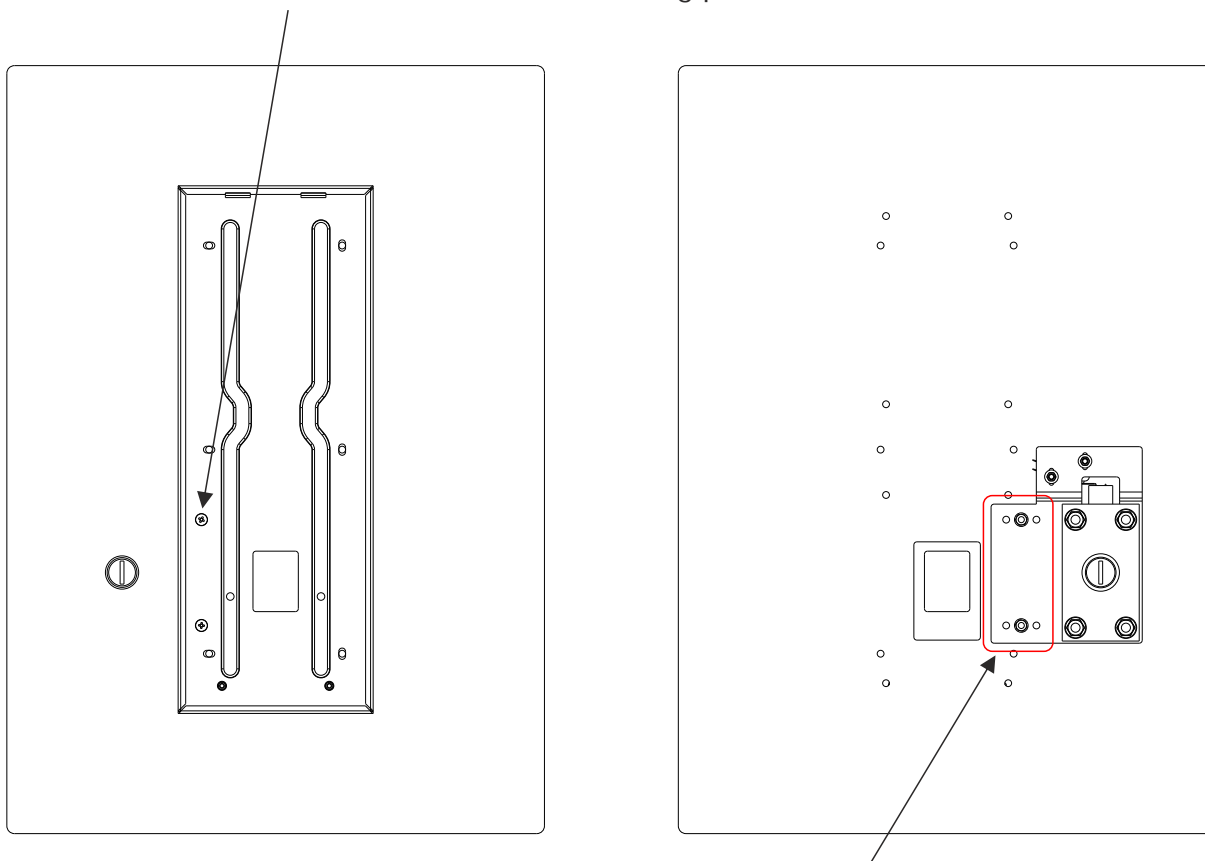

New holes may have to be drilled in this area  
depending on the location of the postal lock assembly

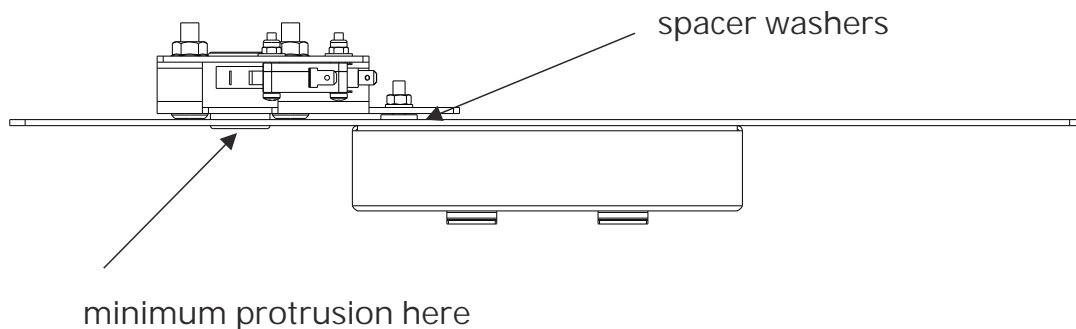

See all installation manuals:  
<https://www.swiftlane.com/swiftlane-installation-manual/>  
Scan QR code to visit all installation manuals

Support  
support@swiftlane.com  
888-884-4005

Sales  
contact@swiftlane.com  
888-915-3779



**SWIFTLANE**

Swiftlane Inc.  
743 Clementina St., San Francisco, CA

Website: <https://www.swiftlane.com>